

SOMERFIELD – STAGE 47

KEYSBOROUGH

Burbank 
#noplacelikehome



**FIXED PRICE HOUSE
& LAND PACKAGE**

Lot 4714 Newson Street,
Keysborough (260m²)

The team at Burbank looks forward to providing affordable living options for all families, enabling you to take your first step towards owning your own home. If you're looking for an investment, an upgrade or a change of scenery, Burbank offers a selection of great homes, with energy-efficient ratings of 6-Star.

Inclusions:

- 2 x Colourboards to choose from
- Timber look laminate flooring
- 2740mm ceilings & 2340mm doors
- Reconstituted stone benchtops
- Stainless steel SMEG appliances
- Front & Rear Landscaping
- Split system air conditioner
- Roller blinds to windows & sliding doors
- 30 year structural guarantee

\$685,000*

Even less with FHOG if applicable

4 BEDROOM HOME

Garage	38.69m ²
Ground Floor	132.92m ²
Porch	4.70m ²
Total	176.31m ²

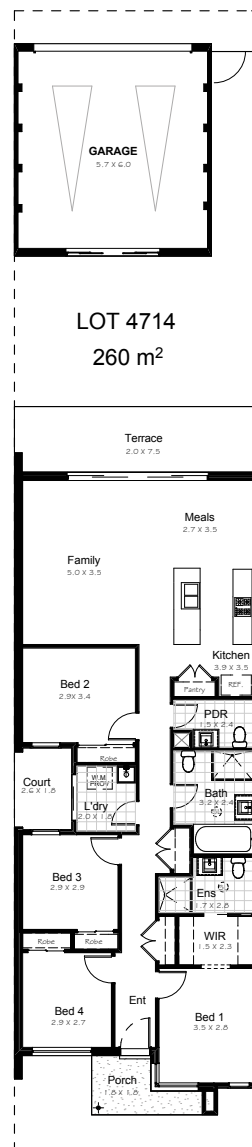

call 13 BURBANK visit burbank.com.au email enquiries@burbank.com.au

Burbank reserves the right to alter any price without notice. Subject to developer design approval. Conditions apply. Images are for illustrative purposes only. All designs are the property of Burbank and must not be used, reproduced, copied or varied, wholly or in part without written permission from Burbank. Copyright Burbank Australia Pty Ltd. ABN 91 007 099 872. Subject to Burbank's preferred siting.

SOMERFIELD – STAGE 47

KEYSBOROUGH



**FIXED PRICE HOUSE
& LAND PACKAGE**

Lot 4714 Newson Street,
Keysborough (260m²)

The team at Burbank looks forward to providing affordable living options for all families, enabling you to take your first step towards owning your own home. If you're looking for an investment, an upgrade or a change of scenery, Burbank offers a selection of great homes, with energy-efficient ratings of 6-Star.

Inclusions:

- 2 x Colourboards to choose from
- Timber look laminate flooring
- 2740mm ceilings & 2340mm doors
- Reconstituted stone benchtops
- Stainless steel SMEG appliances
- Front & Rear Landscaping
- Split system air conditioner
- Roller blinds to windows & sliding doors
- 30 year structural guarantee

\$667,000*

Even less with FHOG if applicable

3 BEDROOM HOME

Garage	38.69m ²
Ground Floor	121.22m ²
Porch	4.70m ²
Total	164.61m²

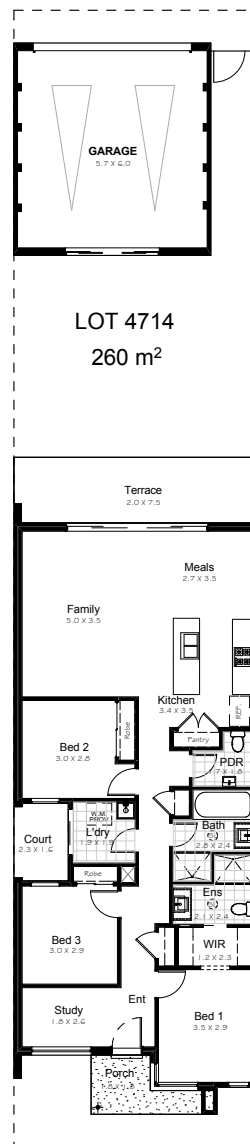

call 13 BURBANK visit burbank.com.au email enquiries@burbank.com.au